



## Use

A dedicated PC connection kit for all Optidrive models, allowing direct connection from the PC to the drive for use with Optitools Studio Software. The USB cable can be plugged into suitable USB type A on the PC and then into the RJ45 communications port on the drive.

## Compatibility

This Option is compatible with the following products:

- CoolVert
- Compact
- P2
- Eco
- E3
- Elevator

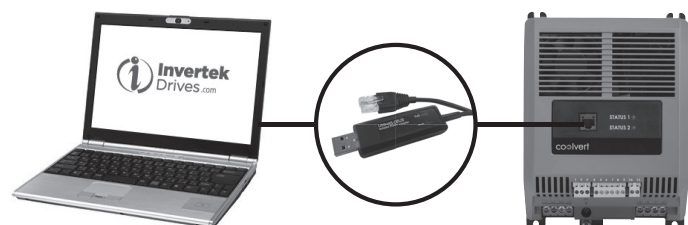

## Model Code

OPT-2-USB485-OBUS

## Technical Data

Temperature Range	0°C - 40°C
Protection Class	IP20
Weight	62
Isolation Class	III
Packaging	W 127cm x D 86cm x H 45cm

- Isolated USB – RJ45 connection adaptor.
- USB2.0.
- Compatible with windows XP, Vista, 7, 8, 8.1, 10 & 11.
- Supports Optitools Studio PC Software connection to the drive.
- 1.5 meter cable length.
- Driver's included in OptiTools for windows 10 & 11

Pin	Function
1	
2	
3	0V
4	RS485- (Optibus)
5	RS485+ (Optibus)
6	
7	
8	

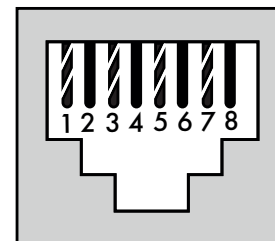

## Safety

**The RJ45 port on the drive is not an Ethernet Port.**

**WARNING** This is not an Ethernet connection. Do not connect directly to an Ethernet port.

**WARNING** When using Modbus RTU or BACnet, ensure that the 0V signal (T3) is used to avoid comms errors and potentially damaging common mode voltages.